

Bitumen impregnated fibreboard

Uses

Bitucell is a compressible, non-extruding, bitumen impregnated fibreboard expansion joint filler suitable for forming joints in in-situ or precast concrete components, and to protect waterproof membranes against physical or mechanical damage.

Forming structural expansion and separation joints in:

- Concrete pavements and floors
- Roads, ramps and runways
- Pedestrian areas
- Concrete retaining walls and bridges
- Concrete basement structures and subways

Advantages

- Easy to handle, cut and tamp
- Resilient
- Will not extrude under compression
- High recovery
- Low distortion

Standards compliance

Bitucell has been independently tested and complies with DTp Specification for Highway Works, Dec 1991 series 1000 clause 1015.

Description

Bitucell is a compressible joint filler and protection board manufactured from bitumen impregnated wood fibres. It is supplied in sheet form and is used to form and fill expansion joints in in-situ and precast concrete construction.

Specification

The expansion joint filler as detailed shall be Bitucell supplied by Al Gurg Fosroc LLC.

The expansion joint filler will have been independently tested and exceed the requirements of the UK Department of Transport Specification for Highway Works series 1000, clause 1015.

Design criteria

Typical sealed expansion joints in roads, industrial floors, runways and other trafficked surfaces.

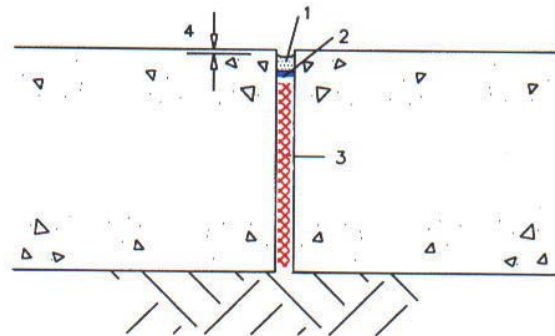

- 1 Colpor 200PF
- 2 Bond breaking tape
- 3 Bitucell
- 4 Recessed seal

An example of a sealed substructure expansion joint is shown below.

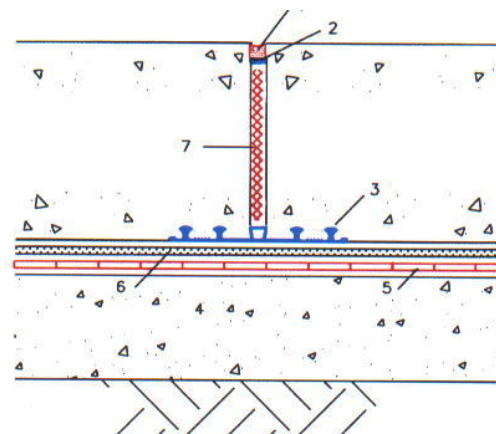

- 1 Thioflex 600 or Nitoseal MS600
- 2 Bond breaking tape
- 3 Supercast rearguard 'S' waterstop
- 4 Blinding concrete
- 5 Proofex GPor Proofex 12 membrane
- 6 Fosroc Protection Board
- 7 Fosroc Bitucell

Fosroc Bitucell

Properties

Form	: Compressible sheet
Solids content	: 100%
Recovery	: Pass (ASTM D1751)
Weathering test	: No disintegration (DTp CI 1015)
Extrusion	: Pass (ASTM D1751)
Distortion	: Pass (ASTM D994)
Brittleness	: Does not crack or shatter (ASTM D994)

Instructions for use

Slabs

Where used to form an expansion joint in in-situ concrete, Bitucell shall be placed against the shuttering on the concreting side before the pour begins. Copper nails may be used to prevent displacement in joints in suspended slabs.

Alternatively, Bitucell may be bonded to the existing slab or previous pour using a suitable contact adhesive. Care should be taken not to contaminate surfaces of the sealing slot with the adhesive.

Joint sealing

A joint sealing slot can be formed by placing a removable timber former on top of the Bitucell. Alternatively, Bitucell can be installed to the full depth of the slab and cut back to the required depth subsequently using a power brush machine. This latter method is generally used for slabs which cannot be cleaned and sealed until all building construction has finished. Bitucell should be tamped down to ensure that it fills the joint completely and provides continuous support for the joint sealant.

Limitations

For conditions of permanent or intermediate immersion use Hydrocell XL

Technical support

Fosroc offers a comprehensive technical support service to specifiers, end users and contractors. It is also able to offer on-site technical assistance, an AutoCAD facility and dedicated specification assistance in locations all over the world.

Estimating

Supply

Bitucell	:	1.22 m x 2.20 m
Nominal sheet	:	
Thickness	:	12 mm 19 mm 25 mm

Storage

As with all organic materials there is a very slight risk of spontaneous combustion if stored long term in wet conditions. Store under cover, in a dry, flat, clean and sound conditions.

Precautions

Health and safety

There are no health hazards associated with Bitucell in normal use.

Fire

Bitucell is combustible and will catch fire if exposed to flame or other sources of ignition.

* Denotes the trademark of Fosroc International Limited

* Denotes the trademark of Fosroc International Limited

† See separate data sheet



Al Gurg Fosroc LLC

Post Box 657, Dubai
United Arab Emirates

www.fosroc.com

Important note

Fosroc products are guaranteed against defective materials and manufacture and are sold subject to its standard Conditions for the Supply of Goods and Service. **All Fosroc datasheets are updated on a regular basis. It is the user's responsibility to obtain the latest version.**

Head Office

telephone: (+9714) 2039699

fax: (+9714) 2859649

email: agf@fosroc.com

Regional offices

Abu Dhabi, Al Gurg Fosroc
Bahrain, YBA Kanoo
Kuwait, Boodai
Oman, Al Amana
Qatar, Tadmur

telephone: 673 1779
telephone: 17738200
telephone: 4817618
telephone: 24815080
telephone: 4432365

fax: 673 1449
fax: 17732828
fax: 4832124
fax: 24817554
fax: 4419517

email: abudhabi@fosroc.com
email: bahrain@fosroc.com
email: kuwait@fosroc.com
email: oman@fosroc.com
email: qatar@fosroc.com

